

TECHNICAL RIDER PRODUCTIESTUDIO 2026

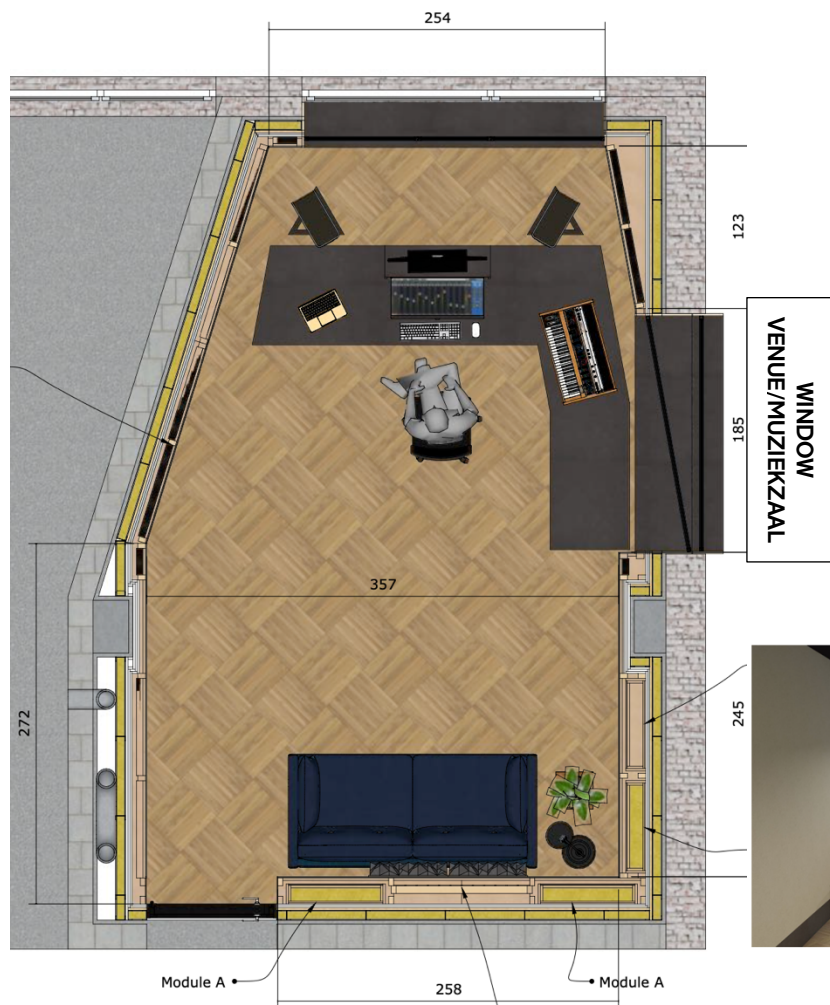
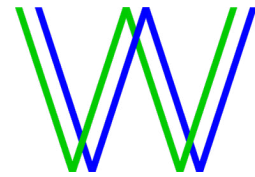

MONITORING & ROUTING

DAD AX64 with 1872×1872 routing
DAD conversion (32 AD + 24 DA)
Neumann KH310 midfield monitors
DAD MOM controller
Easy connection external DAWs - DAD software
RME Digiface Dante optional

PRE-AMPS

16-channel Neve 1073-style rack
16-channel DAD preamp cards
patchbay inserts for external hardware/pre-amps

HEADPHONE MONITORING

Behringer Powerplay System with 6 independent mixes

COMPUTER & DAW

Apple Mac Mini M4 (24 GB RAM, 512 GB SSD)
Pro Tools Studio (iLok included)
Logic / Ableton / Reaper

MICROPHONES*

Condenser & Small Diaphragm
Austrian Audio OC818 Dual Set Go
Neumann KM184 stereo set (2× KM184)
DPA 4099 CORE Classic Kit
2 × DPA 2011

Ribbon

2 x AEA R84
1 x Coles 4038 Stereo Set

*additional studio microphones

For technical specifications regarding dynamic microphones, backline & PA: see technical rider music room
Connection production studio & music room: Ghelmetti patchbay, XLR/BNC/Ethercon panels